

tourism and food, science, and engineering

The Masterplan provides each of the DIT academic areas with a defined space with a distinctive identity while organising them to contribute to the overall cohesive image and vision for the Quarter. In addition, the design of the programmatic space adjacencies recognise the necessary cross-disciplinary interactions that take place.

These three academic areas form three separate, similar, but distinctive quadrangles that primarily open to the south providing access to St. Brendan's Way and the Cultural Garden. The south-facing courtyards allow a greater degree of direct sunlight to fall on the outdoor landscaped spaces and support St. Brendan's Way as a primary circulation route through the campus. A north-south oriented atrium space connects the Engineering school to parts of the DIT Research Centre and Commercial Laboratories via a series of bridges.

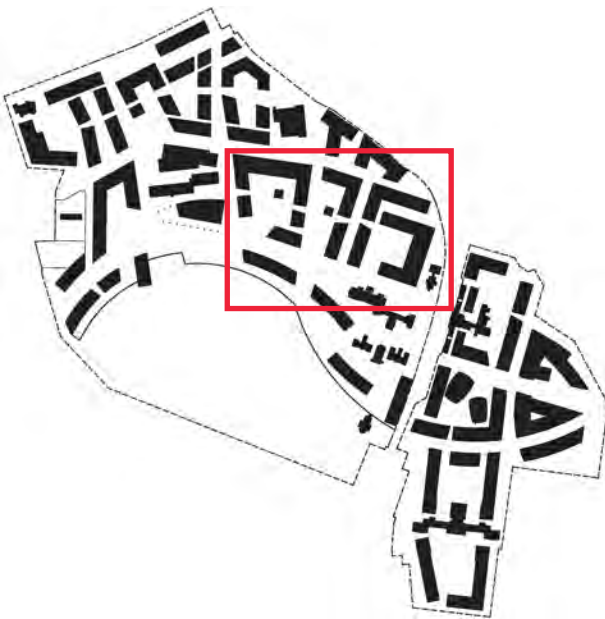

University of Cincinnati Student Life Center, Moore Ruble Yudell Architects and Planners

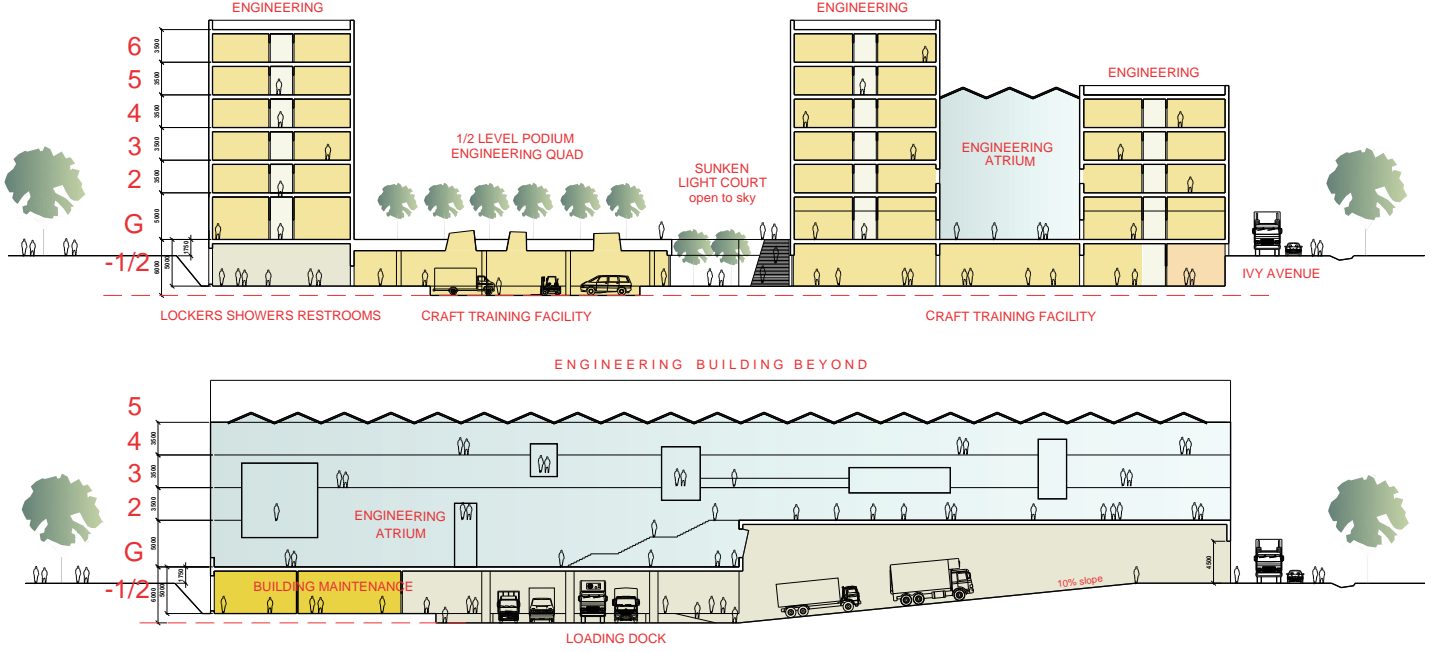

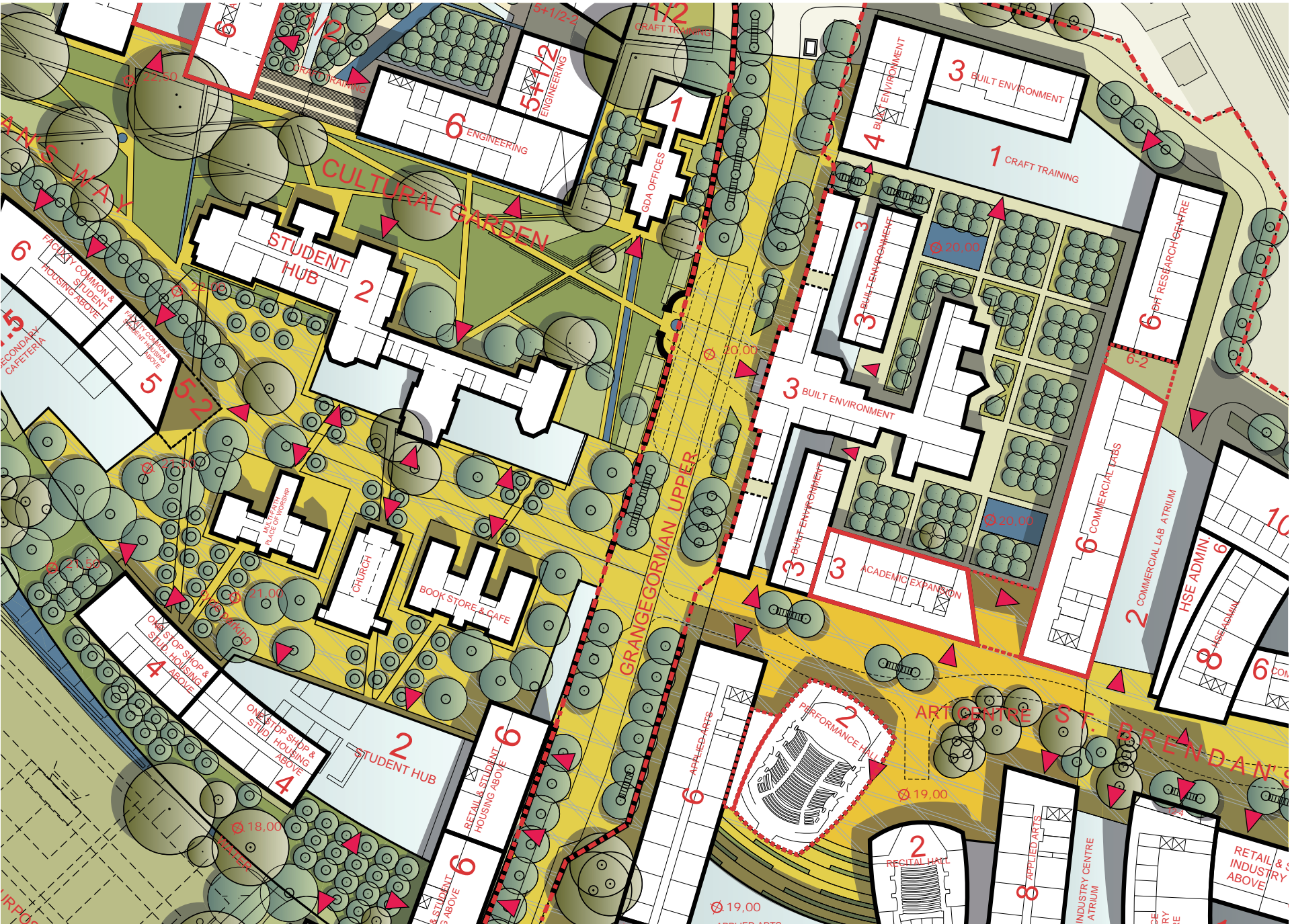
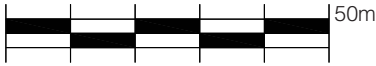

student services, built environment, and the cultural garden

The Student Support Services are grouped as a student “hub” and located in a high profile, easily accessible campus location as part of the cultural-social “heart” of the Grangegorman Quarter. St. Brendan’s Way, the major circulation route through the site, passes between the grouping of protected buildings that, in addition to several new facilities, will comprise the majority of Student Support Services. This hub of student services is complemented by various retail shops, restaurants, cafes and DIT cafeterias along St. Brendan’s Way and is located between the Student Housing to the south and the academic departments to the north—a literal and figurative bridge between the two aspects of student life.

The Built Environment department has its own distinctive courtyard and also occupies the Richmond Penitentiary (Clock Tower building) that will be renovated and expanded. The Clock Tower is seen as a major iconic link from the history of the site to the future of the University and has been given the space required to appreciate the landmark by the design of the Cultural Garden directly opposite it. The Cultural Garden is conceived as a place of reconciliation, celebration and commemoration of the new and protected buildings as well as the past and future uses—a means of marking a significant process of transformation





1. view of cultural garden
looking southeast

The Cultural Garden is an axial space that looks toward the Clock Tower providing an uninterrupted view of this protected structure, and flanks other protected buildings that will be adapted to student social activities.



2. view of cultural garden
looking northeast

The Cultural Garden is conceived as a place of reconciliation, celebration and commemoration of the new and protected buildings as well as the past and future uses—a means of marking a significant process of transformation.





1. view of grangegorman road looking south

Grangegorman Road currently bisects the site. The character of the portion of road through the site will be altered using traffic calming and shared surface concepts to provide a pedestrian dominant space that knits together the two portions of the site.



2. view of grangegorman road looking north

The portion of Grangegorman Road through the site will be treated with a different materiality than the rest of the road relating more to the character of St. Brendan's Way than a city street. The existing protected stone wall will be substantially retained but may be altered in some places to create more open and inviting spaces.



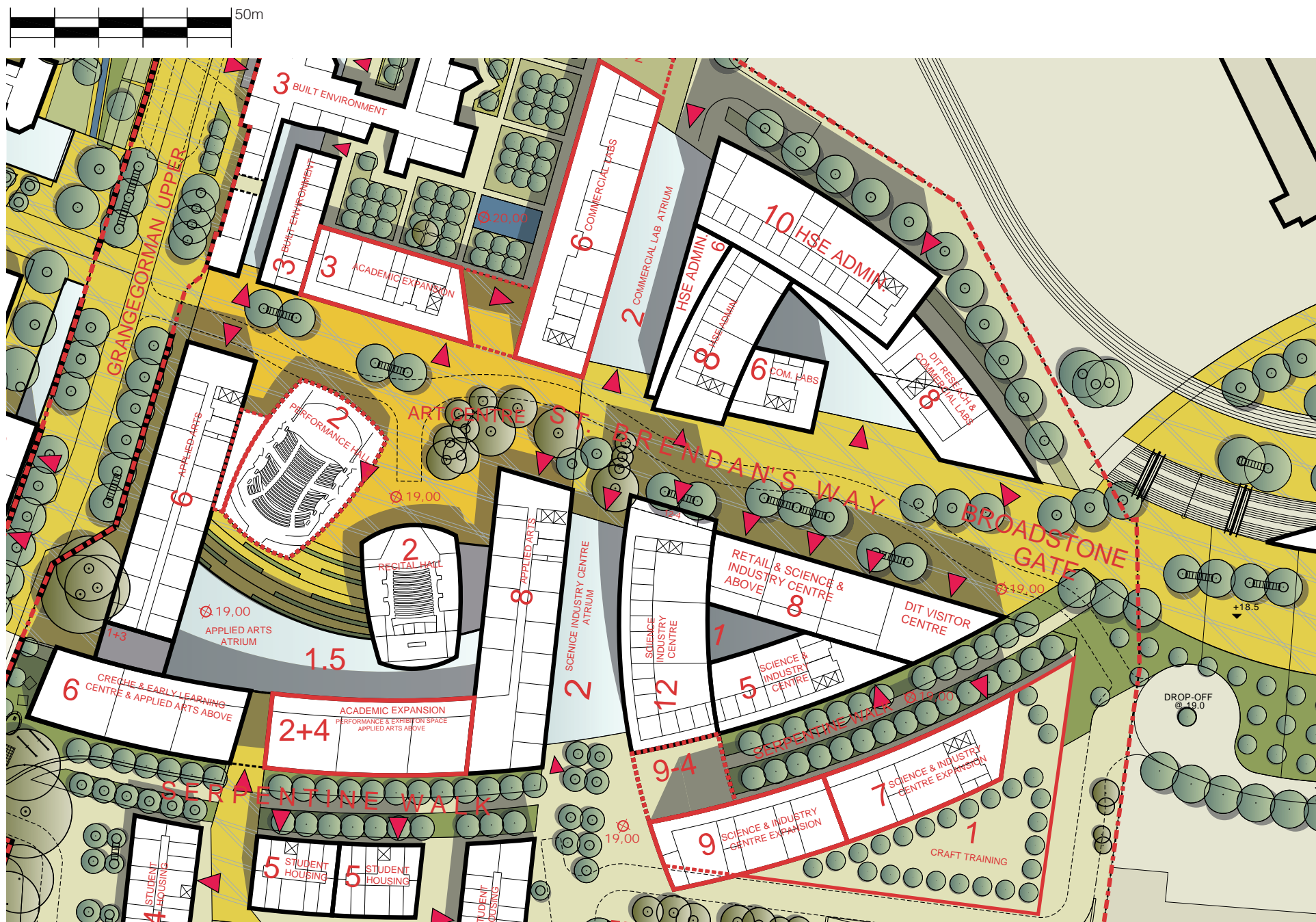

the faculty of applied arts and the arts centre

The facilities dedicated to the Faculty of Applied Arts (FoAA), including the proposed Arts Centre, comprise the second half of the cultural-social “heart” of the Grangegorman quarter. The Arts Centre is envisioned to be a showplace for the artistic creations of the music, drama, art, design and media departments of the Institute and a destination venue for the community and the city of Dublin. The quadrangle dedicated to the Applied Arts department is dominated by a recital hall, a future performance venue and an art gallery—all partially contained within a glazed atrium wintergarden space.

In addition to opening northward to the pedestrian traffic on St. Brendan’s Way, the location for the arts centre was chosen due to its public access and prominence near the Broadstone Gate with its access to the proposed LUAS light rail line, taxis and bus routes. The Applied Arts quad is also accessed from Grangegorman Road and a drop-off for the creche is provided and underground parking garage is located below grade.

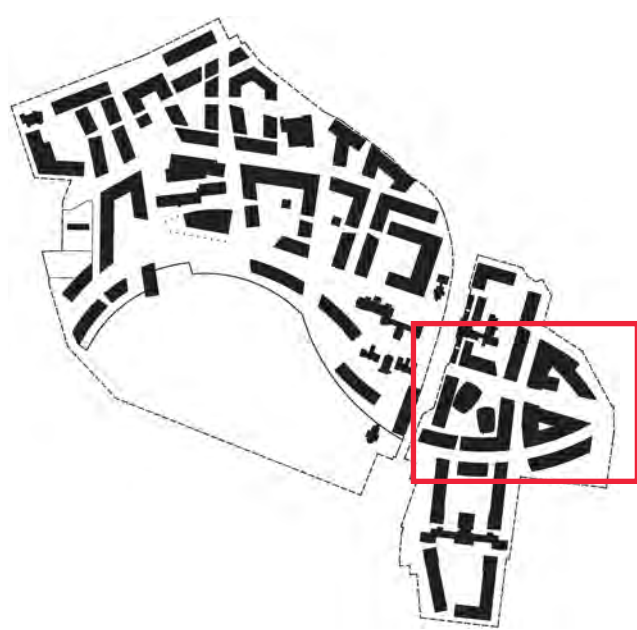

University of Maryland Center for the Performing Arts, Moore Ruble Yudell Architects and Planners



University of Cincinnati Student Life Center, Moore Ruble Yudell Architects and Planners



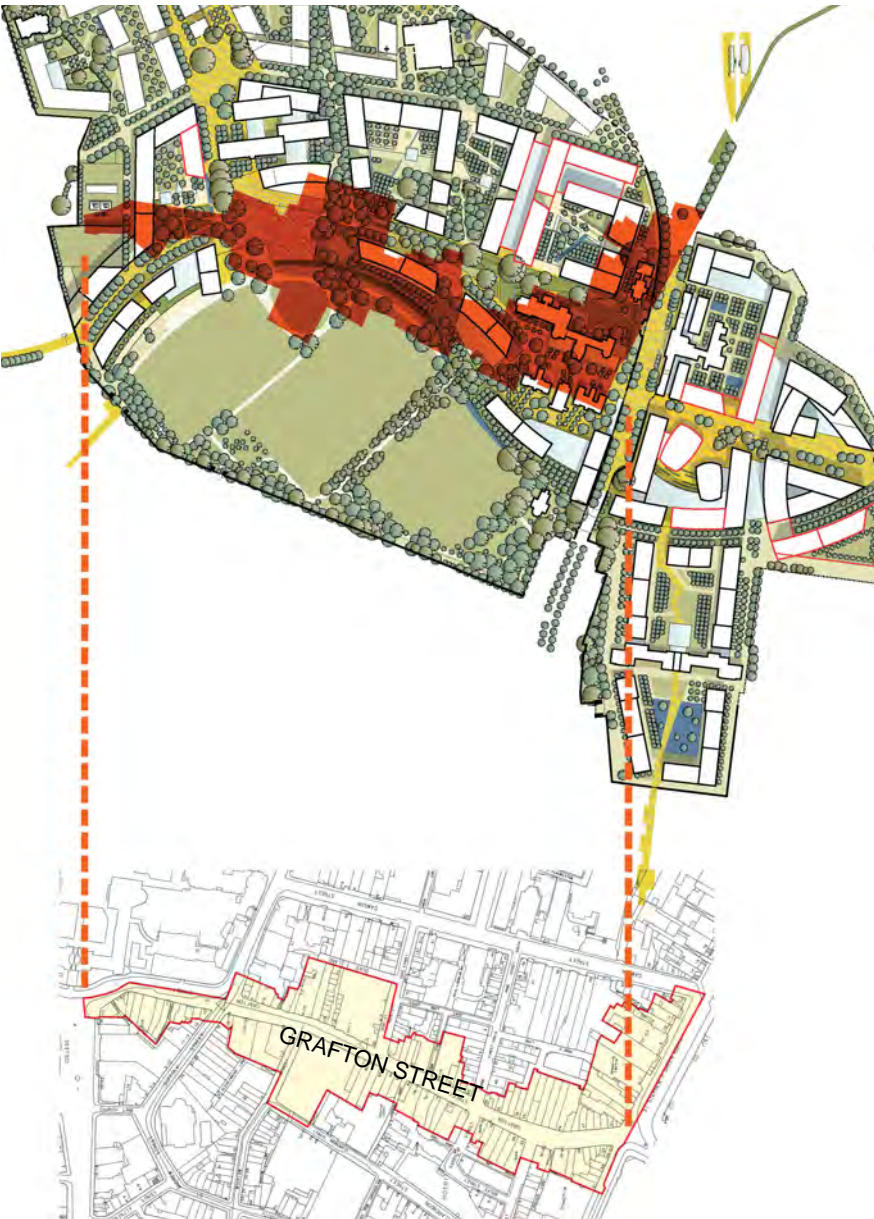

Size comparison between St. Brendan's Way and Grafton Street



Social gathering spaces along St. Brendan's Way and the Serpentine Walk

st. brendan's way and the serpentine walk

St. Brendan's Way and the Serpentine Walk are key design principles considered to be required for the successful implementation of the Masterplan. Both are major organisational and circulation paths through the site but with differing character. The urban quality of St. Brendan's Way is complemented by the landscaped nature of the Serpentine Walk—a meandering link that traverses the site in two grand arcs, giving a south-facing green edge to student residence halls. The Serpentine Walk is to be a link in the landscape path from the Grand Canal and the Phibsborough / Mountjoy area to the north through the Grangegorman site and out to Phoenix Park to the west. In addition, the Serpentine Walk acts as a collector for several of the north-south oriented “green finger” landscape parks that bring people into the site from the edges of the quarter via a serene park-like setting.

The diagram to the left shows a size comparison between St. Brendan's Way and Dublin's popular and much travelled and understood pedestrian way—Grafton Street.

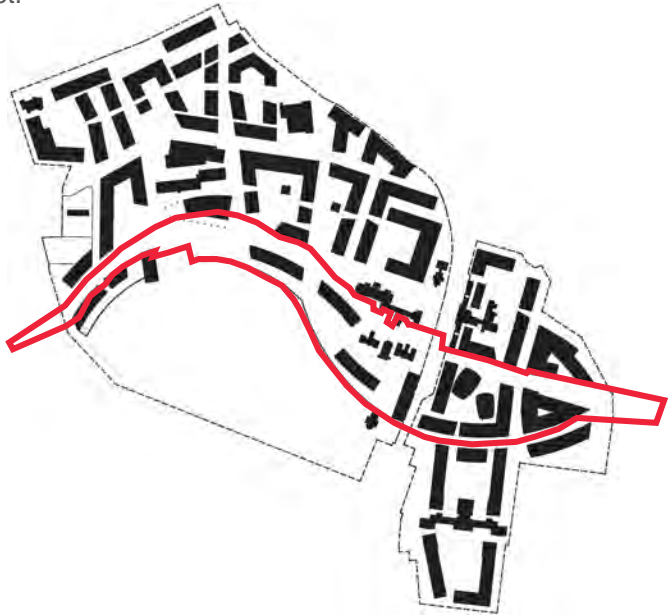

View of Grafton Street



The Serpentine Walk and the Green Finger Parks



Precedent images for a portion of the Serpentine Walk

landscape design: st. brendan's way

The design for St. Brendan's Way strives to provide a high quality of surface materials, street furniture, lightning, and a significant planting concept in order to establish a clear understanding of the importance and hierarchy of this very public open space. Paving materials include a warm natural stone in various colours to provide an engaging, almost painterly character. Spacious clusters of street furniture and sculpture along the pedestrian zone provide places for pedestrians to meet, sit down and observe the vibrant life in the District. Carefully selected lighting will give St. Brendan's Way effective and expressive illumination at night.

Overall, St. Brendan's Way has a harmonious character in scale, colours and materials. Existing trees have been integrated into the landscaping concept throughout. The Masterplan intends to keep the site vehicle free as much as possible. Due to the traffic and access requirements, there will be shared uses on circulation paths, but these will be clearly prioritised for pedestrians and cyclists. Vehicular use will be limited and controlled. No road markings or signs will be provided, in order to prioritise pedestrians and ensure slow vehicular traffic.

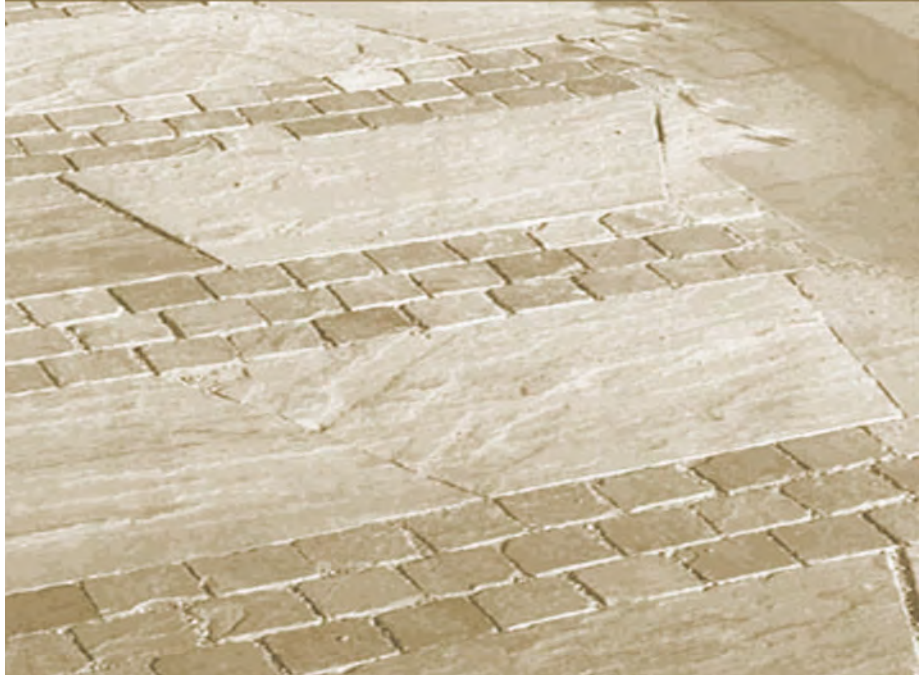
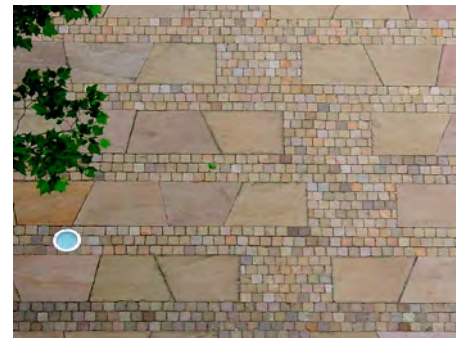
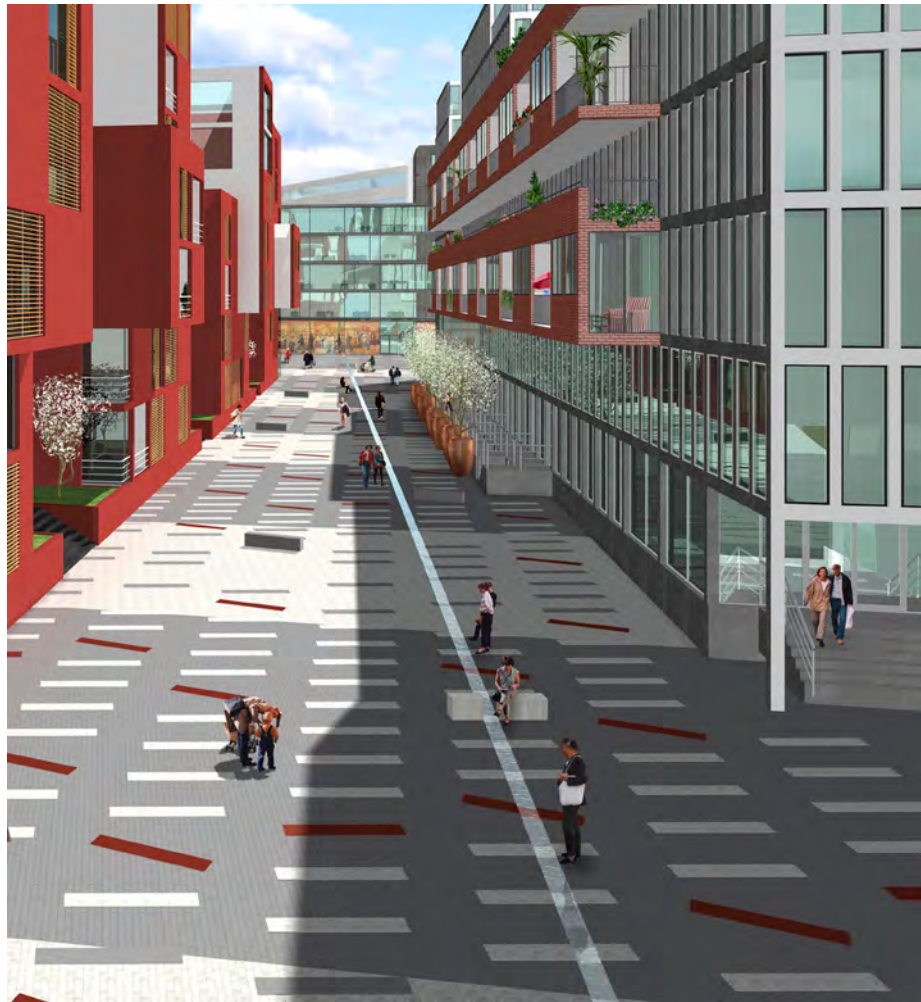
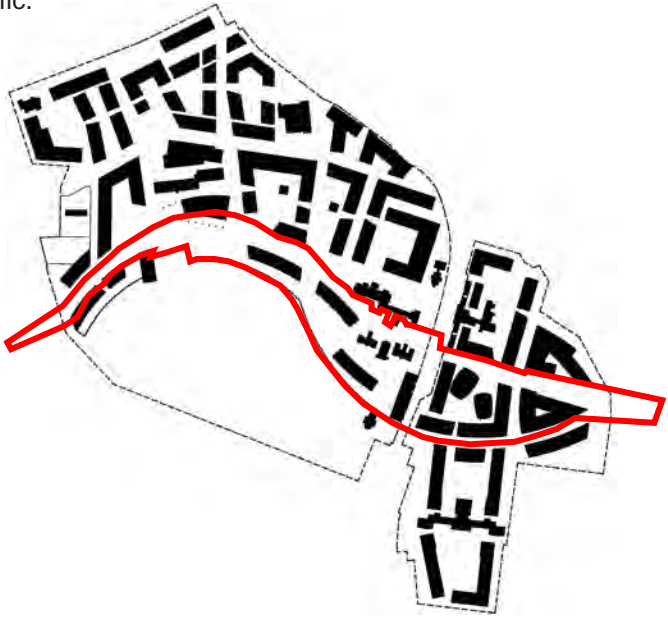



1. view of library square and the top house looking south toward the DIT library

Library Square will provide a public space that activates a central portion of the site bringing people together from the HSE buildings, DIT and the Public City Library. A view corridor from North Circular Road, past the protected portion of the DIT Library and out over the Fields will create an important link through the site.



2. view of st. brendan's way and the wellington monument looking southwest

Breaks through the student housing buildings along the Serpentine Walk provide views out from the site and allow daylight to penetrate and cross St. Brendan's Way.



student housing

Providing student accommodations within the boundaries of the Institute will create a lively and energetic place for learning and living. By locating the Student Housing along the spine of the Serpentine Walk, the housing does not become segregated to the periphery of the Institute and in addition creates opportunities for interaction all through the site along St. Brendan's Way and the Serpentine Walk. The best views of the city and the mountains are from the housing where much of the indoor living and socialising of the students will happen.

The quality of construction and the overall architectural expression of the Student Housing will be important due to its prominent location within the masterplan and the its high-profile view from the surrounding city.

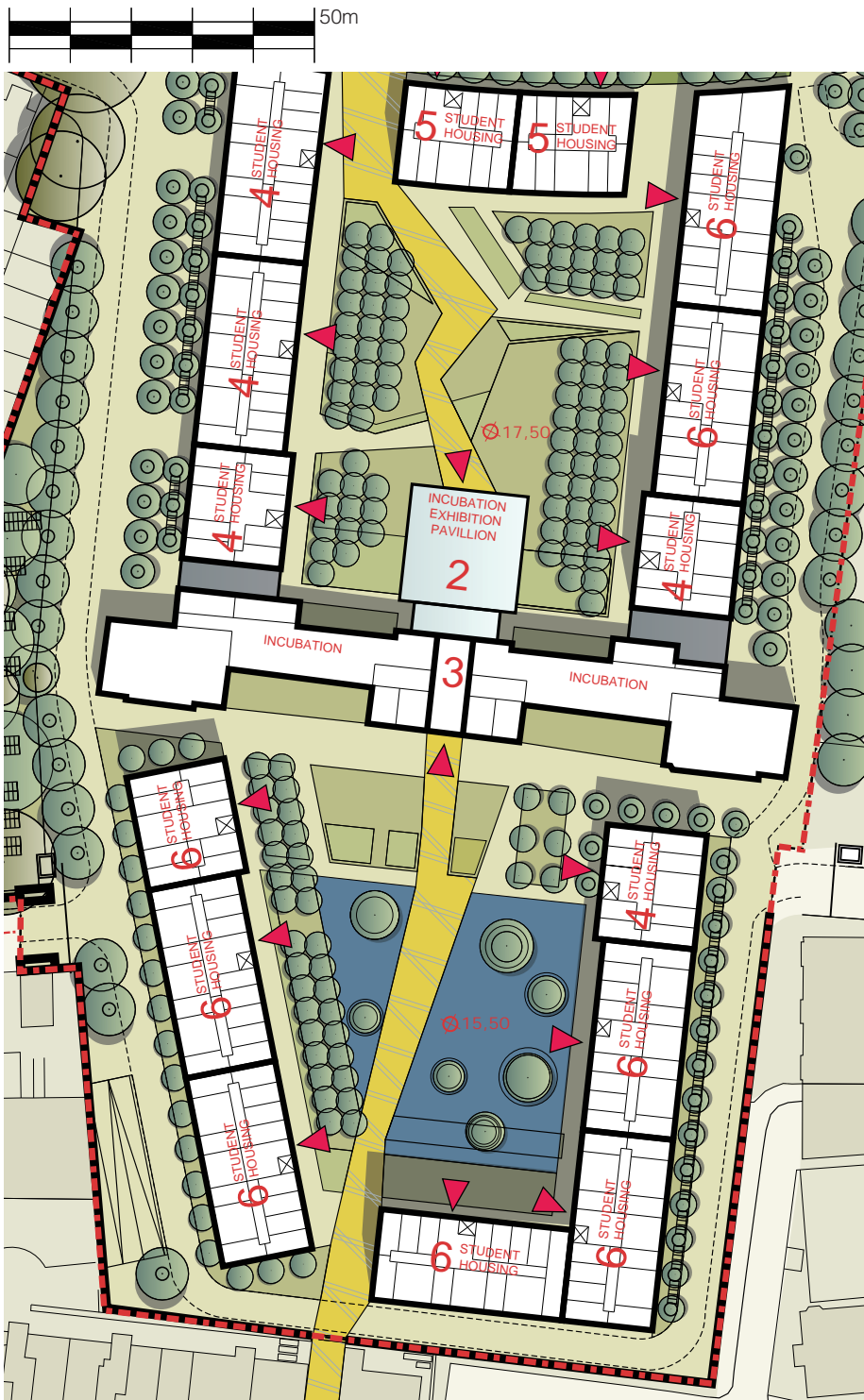

Titgen Student Housing, Denmark, Lundgaard & Tranberg Architects

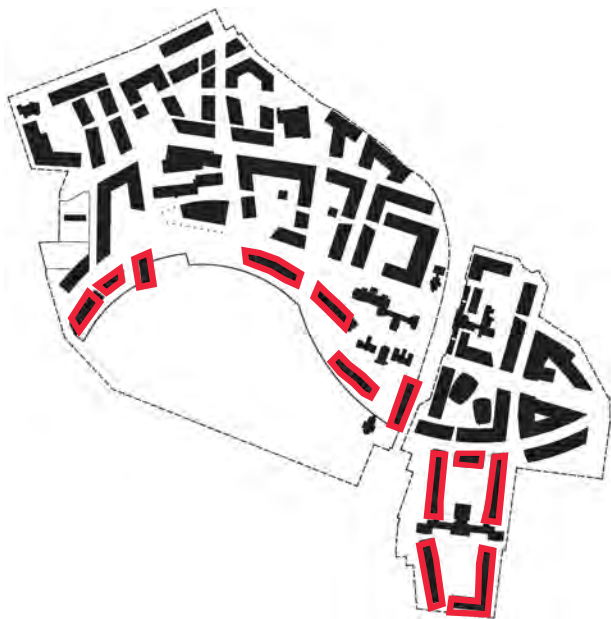



science and industry centre

The Grangegorman Science Park is envisioned as a major hub of intellectual capital on campus and a place where knowledge is created and transferred to enterprise, and where the latest developments in education, research and scholarly activity take place. It will be a place of true networking and collaboration between professionals and students in academia and leaders in science research, business and industry.

The Science and Industry Centre shares space at one of the most prominent locations of the site. The Broadstone Gate is a major linkage between the Grangegorman Quarter and the city and the design and construction of the buildings at this gateway will become one of the new identities for the Dublin Institute of Technology. In addition to the practicality of the location due to its proximity to the proposed LUAS light rail line, taxis and bus routes on Constitution Hill and the location of underground parking, the Science and Industry Centre is located to act as a figurative bridge between academic culture and the business of the city.



Duke University Science Center, Moore Ruble Yudell Architects and Planners



Duke University Science Center, Moore Ruble Yudell Architects and Planners



Duke University Science Center, Moore Ruble Yudell Architects and Planners