

st. brendan's way  
and the serpentine walk

St. Brendan's Way and the Serpentine Walk are key design principles considered to be required for the successful implementation of the Masterplan. Both are major organisational and circulation paths through the site but with differing character. The urban quality of St. Brendan's Way is complemented by the landscaped nature of the Serpentine Walk—a meandering link that traverses the site in two grand arcs, giving a south-facing green edge to student residence halls. The Serpentine Walk is to be a link in the landscape path from the Grand Canal and the Phibsborough / Mountjoy area to the north through the Grangegorman site and out to Phoenix Park to the west. In addition, the Serpentine Walk acts as a collector for several of the north-south oriented “green finger” landscape parks that bring people into the site from the edges of the quarter via a serene park-like setting.

The diagram to the left shows a size comparison between St. Brendan's Way and Dublin's popular and much travelled and understood pedestrian way—Grafton Street.



Size comparison between St. Brendan's Way and Grafton Street



Social gathering spaces along St. Brendan's Way and the Serpentine Walk

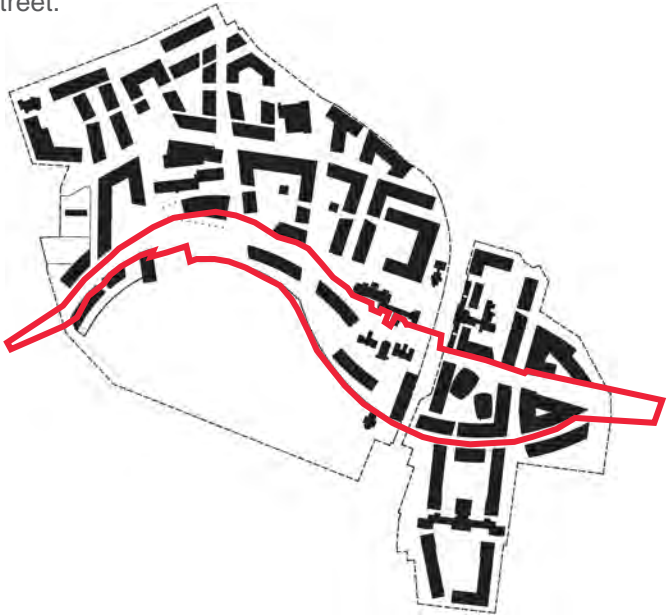

View of Grafton Street



The Serpentine Walk and the Green Finger Parks



Precedent images for a portion of the Serpentine Walk



landscape design: st. brendan's way

The design for St. Brendan's Way strives to provide a high quality of surface materials, street furniture, lightning, and a significant planting concept in order to establish a clear understanding of the importance and hierarchy of this very public open space. Paving materials include a warm natural stone in various colours to provide an engaging, almost painterly character. Spacious clusters of street furniture and sculpture along the pedestrian zone provide places for pedestrians to meet, sit down and observe the vibrant life in the District. Carefully selected lighting will give St. Brendan's Way effective and expressive illumination at night.

Overall, St. Brendan's Way has a harmonious character in scale, colours and materials. Existing trees have been integrated into the landscaping concept throughout. The Masterplan intends to keep the site vehicle free as much as possible. Due to the traffic and access requirements, there will be shared uses on circulation paths, but these will be clearly prioritised for pedestrians and cyclists. Vehicular use will be limited and controlled. No road markings or signs will be provided, in order to prioritise pedestrians and ensure slow vehicular traffic.

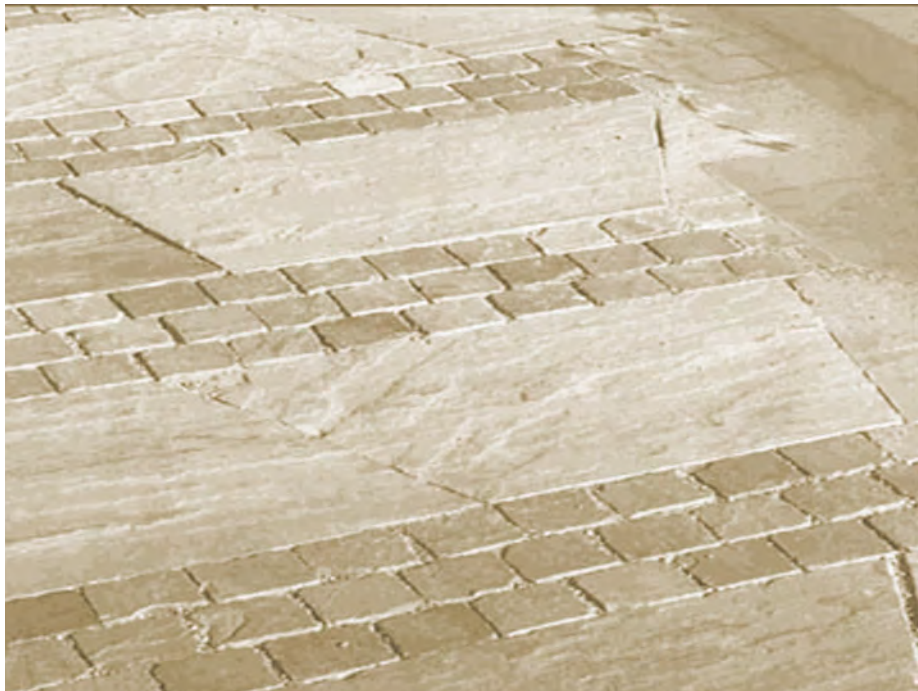
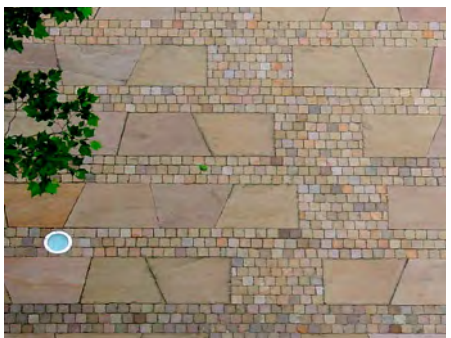
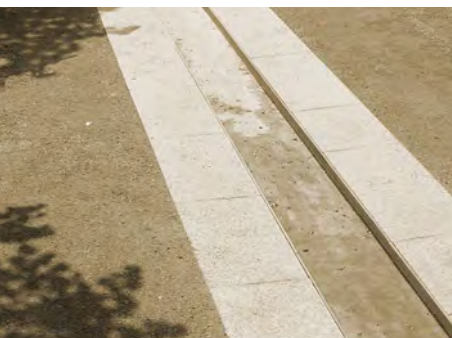
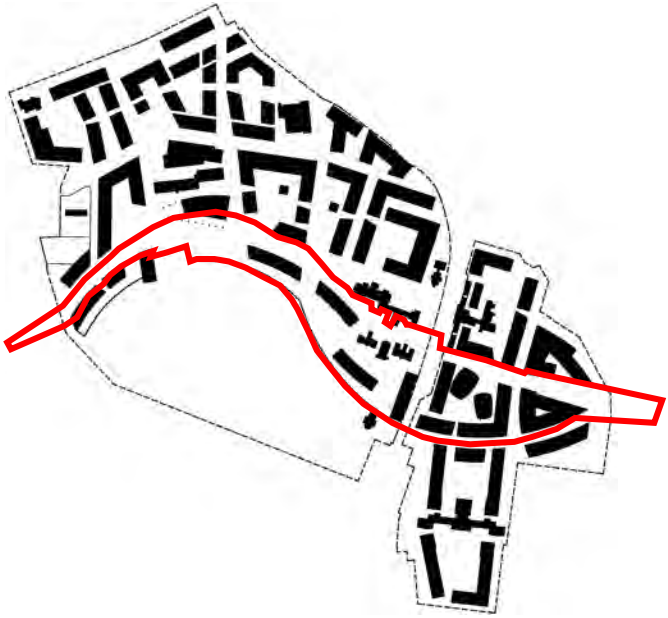





1. view of library square and the top house looking south toward the DIT library

Library Square will provide a public space that activates a central portion of the site bringing people together from the HSE buildings, DIT and the Public City Library. A view corridor from North Circular Road, past the protected portion of the DIT Library and out over the Fields will create an important link through the site.



2. view of st. brendan's way and the wellington monument looking southwest

Breaks through the student housing buildings along the Serpentine Walk provide views out from the site and allow daylight to penetrate and cross St. Brendan's Way.





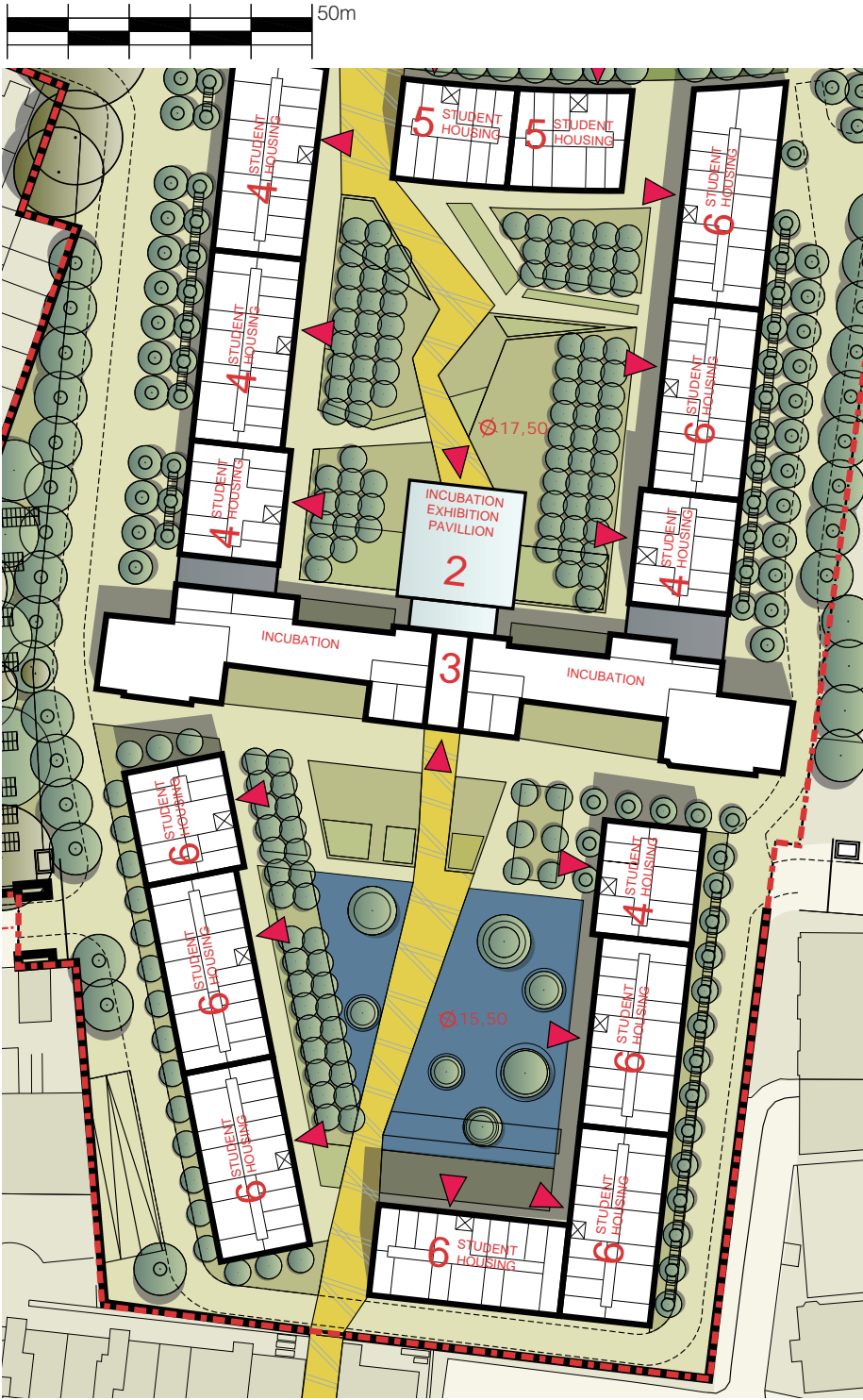

Titgen Student Housing, Denmark, Lundgaard & Tranberg Architects

student housing

Providing student accommodations within the boundaries of the Institute will create a lively and energetic place for learning and living. By locating the Student Housing along the spine of the Serpentine Walk, the housing does not become segregated to the periphery of the Institute and in addition creates opportunities for interaction all through the site along St. Brendan's Way and the Serpentine Walk. The best views of the city and the mountains are from the housing where much of the indoor living and socialising of the students will happen.

The quality of construction and the overall architectural expression of the Student Housing will be important due to its prominent location within the masterplan and the its high-profile view from the surrounding city.

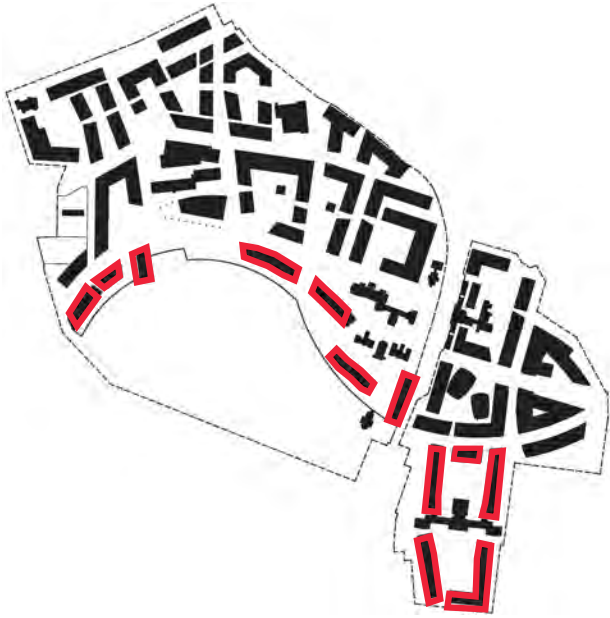





**science and industry centre**

The Grangegorman Science Park is envisioned as a major hub of intellectual capital on campus and a place where knowledge is created and transferred to enterprise, and where the latest developments in education, research and scholarly activity take place. It will be a place of true networking and collaboration between professionals and students in academia and leaders in science research, business and industry.

The Science and Industry Centre shares space at one of the most prominent locations of the site. The Broadstone Gate is a major linkage between the Grangegorman Quarter and the city and the design and construction of the buildings at this gateway will become one of the new identities for the Dublin Institute of Technology. In addition to the practicality of the location due to its proximity to the proposed LUAS light rail line, taxis and bus routes on Constitution Hill and the location of underground parking, the Science and Industry Centre is located to act as a figurative bridge between academic culture and the business of the city.



Duke University Science Center, Moore Ruble Yudell Architects and Planners



Duke University Science Center, Moore Ruble Yudell Architects and Planners

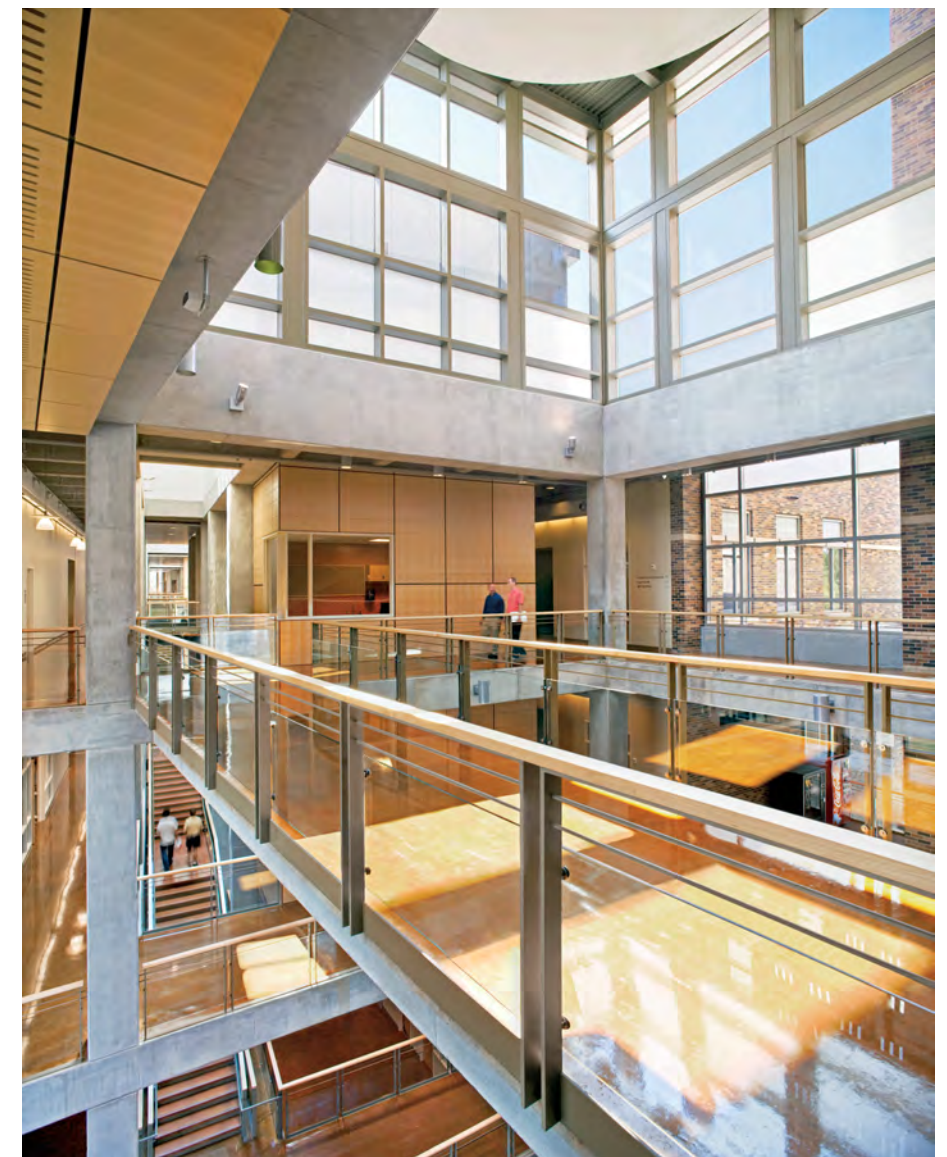

Duke University Science Center, Moore Ruble Yudell Architects and Planners