

A photograph of a modern building with stone and brick walls, a paved walkway, and a wooden frame structure in the foreground. The building features a mix of grey stone and light-colored brickwork. A paved path leads towards the building, flanked by greenery and a wooden frame structure. A large tree is visible on the left side of the image.

**GDA CONSULTATIVE GROUP – 22<sup>ND</sup> JUNE 2017**

**Ronan Doyle  
Grangegorman Development Agency**



# OVERVIEW



## Update

- Health
- DIT
- Other Projects
- Communications
- Public Art



# PRIMARY CARE CENTRE



Grangegorman  
Development Agency  
Gníomhaireacht Forbartha  
Ghráinseach Ghormáin

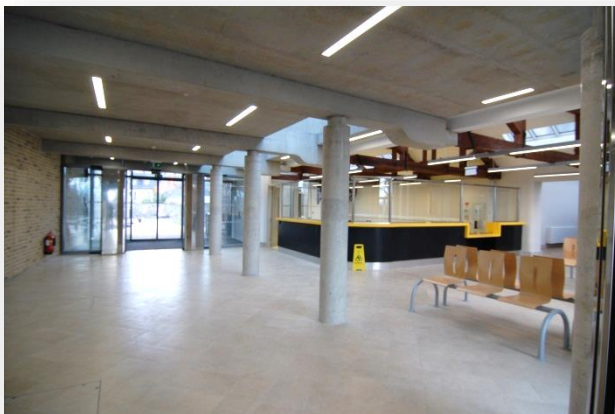



# RESIDENTIAL CARE CENTRE



Grangegorman  
Development Agency  
Gníomhaireacht Forbartha  
Ghráinseach Ghormáin



# CENTRAL AND EAST QUADS





## Academic Hub

- OD+T have started mobilising their team to undertake Stage 2A i.e Planning Submission
- Planning anticipated target date October 2017

## Energy Centre

- Will be submitted for planning shortly

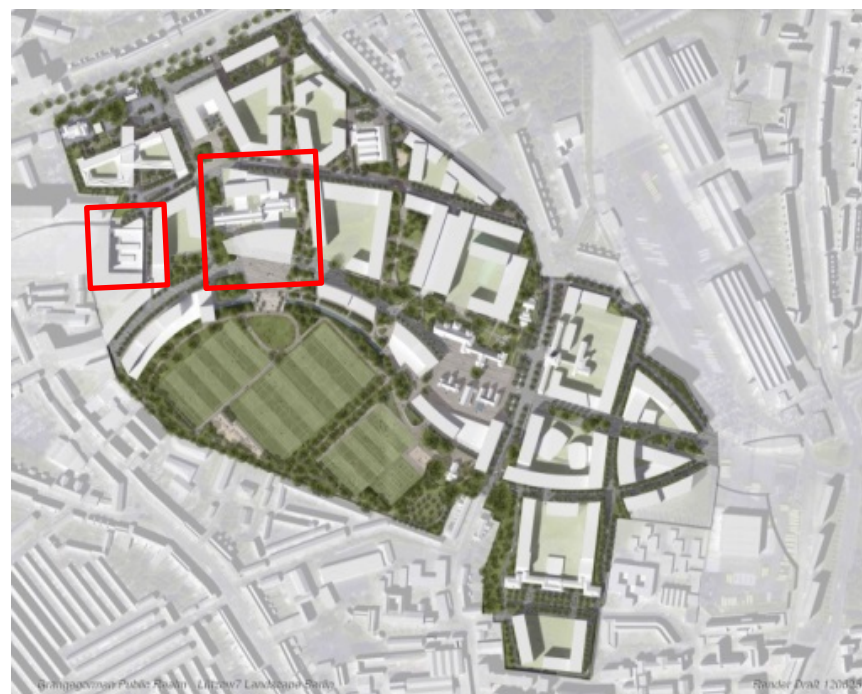

# PRIMARY SCHOOL D7ETNS



Grangegorman  
Development Agency  
Gníomhaireacht Forbartha  
Ghráinseach Ghormáin



Scoil Náisiúnta  
Baile Átha Cliath 7  
Ag Foghlaim le Chéile

Dublin 7 Educate Together  
National School



- Multi-denominational
- Co-educational
- Child centered
- Democratically run



# LABOUR AND LEARNING FORUM



## ***GLLF Business and Enterprise Group:***

- Successful Grangegorman Business Breakfast took place on Tuesday 16<sup>th</sup> May at St Laurence's . Speakers included GDA CEO, DCC LEO and SPADE Enterprise Centre.
- Business breakfasts planned for September and November

## ***Intreo and DDLETB:***

- 5-week full-time 'General Operative – Construction' course concluded on 28<sup>th</sup> April with inputs from **EAccess to Apprenticeship:**
- Active partners in promotion and recruitment phase of DIT-based project. Recruitment now underway for first course in September

## ***Grangegorman ABC (Area-based Childhood) project:***

- Progressing work around referral pathways, programme sustainability and evaluation.



## Ongoing Communications

- Communications Review underway. Murray Consultants currently working on desktop review
- Online survey currently live
- Most recent newsletter delivery complete
- Drafting proposal for Grangegorman history project



# Grangegorman History Project

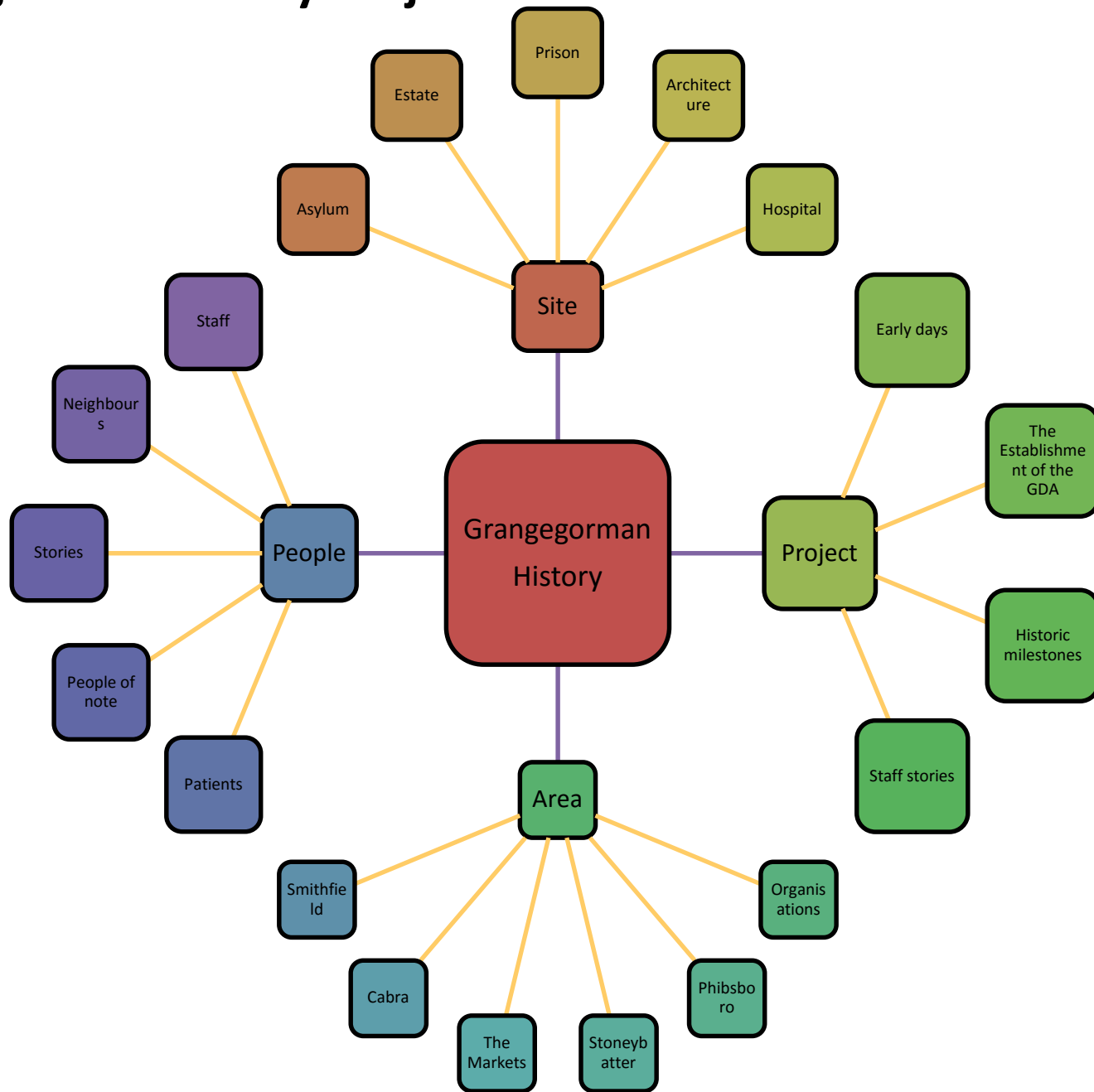



## Meetings

- Community Liaison Committee took place on Wednesday 17<sup>th</sup> May.
- This was a special meeting focusing on the operations of the Community Liaison Committee. Some suggestions included:
  - Sending the minutes of the meeting out to registered groups to get them involved
  - Asking for volunteers from the registered groups to attend the meetings
  - Greater focus on positive messages
  - Full Report on recommendations to follow

'...the lives  
we live'<sup>1</sup> **grangegorman  
public art**



*(Pathway 3) 1916 A Revolutionary Cabaret, St. Laurence's.*

- P1 : Major Commission – Project Pre-planning
- P2: 12 projects ongoing (see recent): Networking day on Tuesday 20<sup>th</sup> June.
- P3: Cultural Mapping (see sample project above)
- P4 : Creative Agents - Ongoing
- P5 : Conference – 23.05. Planning Meeting
- P6 : *Installation of artworks later this year; lending of George Warren sculpture for Greenway hub in process*

Next PAWG mtg. 13<sup>th</sup> June.



*Christina Henri's Bonnet project*

## 4 new Pathway 2/Round 3 projects:

*To be. To Wallow. To Wonder.* Artist Marie Hensey in collaboration with Kids Own Publishing and DIT Early Childhood Education.

*Incarceration Alters.* Artist Bernie Masterson in partnership with the Irish Prison Service and the CDETB

*Grown Home.* Artist Hilary Murray in the production of a culinary digital archive for Grangegorman

*Framing Identity.* Artist Brian Cregan working with young in the neighbourhood in partnership with DIT.





GHRÁINSEACH GHORMÁIN  
GRANGE GORMAN

THANK YOU